

Series 540, Model 1-1 1/2 with Mechanical Seal

Subject to change without notice
F.O.B. Windsor, Ontario

Supersedes all previous parts lists

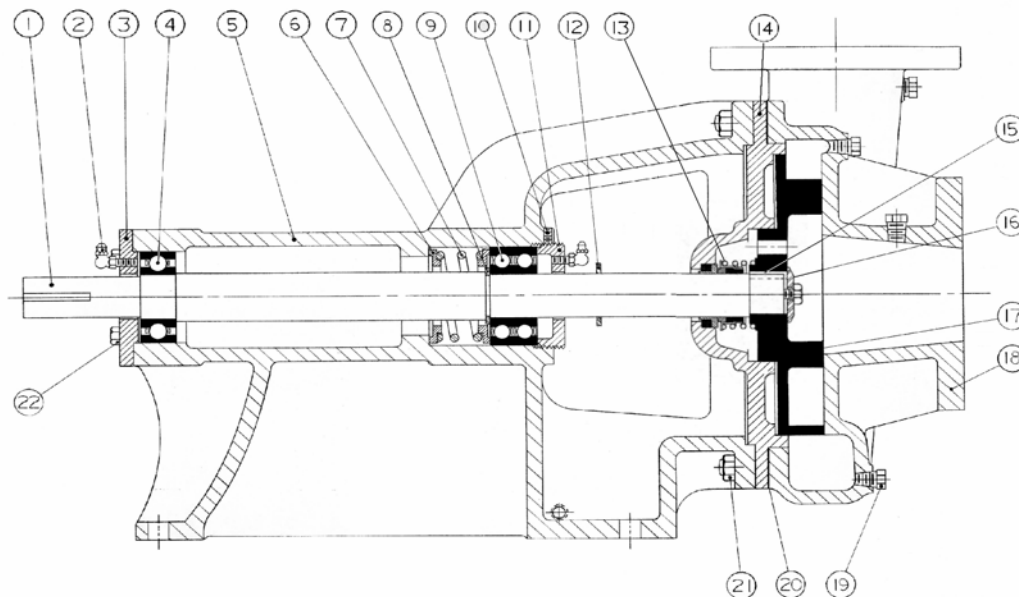

ITEM	DESCRIPTION	MATERIAL	PART NUMBER	QTY	PRICE
1	Shaft	Steel	480-12-400-640	1	
		304 Stainless Steel	480-13-400-550	1	
2	Grease Fitting	1/4-28 90 Deg. Grease Fitting	325-10-025-605	2	
3	Bearing Cap	Iron	180-12-100-310	1	
4	Outer Ball Bearing	Steel - 6206C3	150-10-125-605	1	
5	Bracket	Iron	165-12-050-310	1	
6	Spring Retainer	Aluminum	145-12-050-010	2	
7	Spring	Spring Steel - M1631A	495-10-050-605	1	
8	Retaining ring	Spring Steel - 1460-118	430-10-025-605	1	
9	InnerBall Bearing	Steel - 3306CS	150-00-225-605	1	
10	Set Screw	5/16-18X5/16 Cup Point Set Screw	355-00-291-660	1	
11	Adjusting Nut	Iron	100-12-025-310	1	
12	Shaft Flinger	Rubber	240-10-400-450	1	
13	Mechanical Seal	Buna / Carbon vs ceramic / SS -BF1C1	335-00-150-040	1	
		Viton / Carbon vs Ceramic / SS - XP1C1	335-00-150-050	1	
14	Back Plate	Iron	110-12-050-310	1	
15	Square Key	1/4X1/4X7/8 Keystock	310-10-050-530	1	
16	Impeller Fasteners	Washer - Stainless Steel - C2590-4	515-10-050-530	1	
		1/2-13X1 1/4 Hex Cap Screw	355-00-123-530	1	
		1/2" Lockwasher	355-00-538-530	1	
17	Impeller ***	Iron	305-12-440-310	1	
18	Casing	Iron	190-12-075-310-S	1	
19	Pipe Plug	1/4-18 Hex Head Plug	390-00-125-605	4	
20	Casing Gasket	Standard	245-10-060-240	3	
21	Casing Fasteners	7/16-14X2 1/2 Hex Cap Screw Grade 5	355-00-103-670	6	
		7/16-14X2 1/2 T5/8 N1 3/8 Stud	355-00-436-620	2	
		7/16-14 Heavy Hex Nut	355-00-588-660	8	
22	Bearing Cap Bolts	5/16-18X3/4 Hex Cap Screw-Grade 5	355-00-035-670	4	

*** Specify the impeller diameter or serial number with every order.
Casing may not be exactly as shown.